

Billi **Alpine**... easy to install

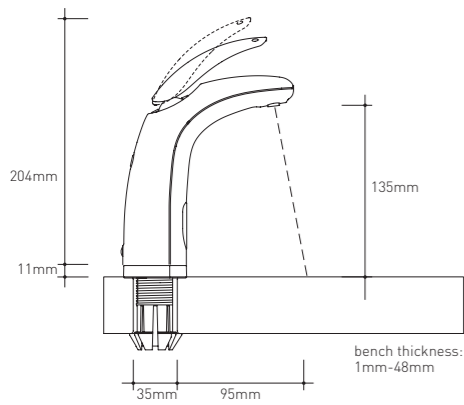

Billi Dual-Temp Dispenser dimensions

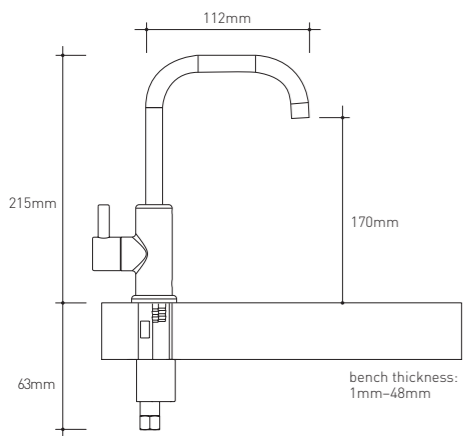

Billi Mini Chilled Square Dispenser dimensions

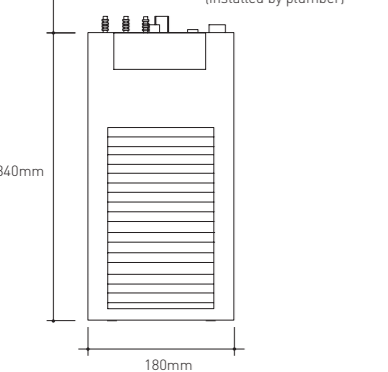
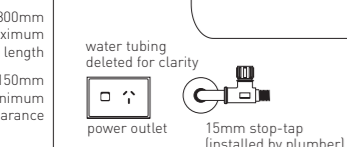
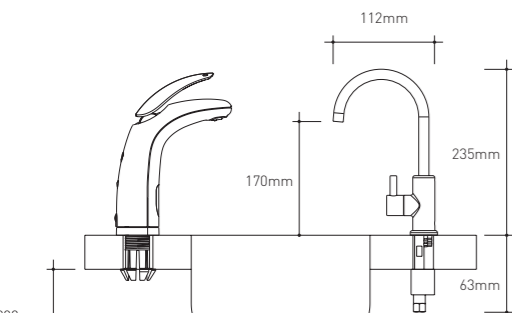

Minimum cupboard dimensions:  
490mm height x 180mm width x 460mm depth  
Preferred installation layout

**Easy installation**

The Billi **Alpine** Dual-Temp Dispenser features a unique dispenser top-mounting system, making it a plumber's dream to install. No more tortuous reaching up behind sink bowls to secure clamps or tubes. The 'snap-fit' base is secured into the mounting hole, pipework is fed through from the top and the dispenser securely clips into place.

**Water supply**

A single 15mm (1/2") stop-tap with a male thread should be installed in an easily accessible position. Water supply must be microbiologically safe to drink, with a minimum dynamic water pressure of 250kPa.

**Power supply**

A standard 10 Amp power outlet is required in the cupboard area where the unit is to be installed. All **Alpine** models are supplied with a 1 metre flex cord and plug.

**Replacement filters**

Periodic replacement of filter cartridges is necessary to maintain water quality. Genuine replacement Billi filter cartridges are available from authorised Billi agents. Cartridges are also available to suit the particular needs of different water supply areas. All Billi filters are NSF42 certified and optional sub micron filters are NSF53 certified to safely remove health threatening giardia and cryptosporidium.

**Commitment to quality**

Reliability has been engineered into the Billi **Alpine** as an imperative in the design process. Proven, high quality materials have been carefully selected for maximum dependability and longevity. The **Alpine** is manufactured to exacting production standards, in line with Billi's long-term commitment to quality.

**24 Month Warranty**

All components of the Billi **Alpine** are covered by a **24 month warranty**. Filter cartridges are a consumable and are not covered by warranty, as water conditions and usage vary.

**Certifications**

Every Billi drinking water appliance is manufactured under a certified quality control system. The Billi **Alpine** has been tested and complies with all required standards including: Watermark Licence Number 21882; Tested to ATS 5200.105:2005; AS/NZS ISO 9001 Certificate Number QEC 11627; C-Tick approved; Complies with AS1428 requirements for Access for the Disabled and section J6 of the BCA. Electrical compliance number CS100600V.



**Billi Pty Ltd**  
42 Lucknow Crescent Thomastown  
Victoria 3074 Australia  
Telephone +61 3 9469 0400  
Facsimile +61 3 9469 0499  
Website [www.billi.com.au](http://www.billi.com.au)

**Designed and manufactured in Australia**

As Billi Pty Ltd has a policy of continual improvement, all details are subject to change without notice. All goods are sold subject to our published terms and conditions.

Billi is a registered Trade Mark. Alpine is a Trade Mark. A0811

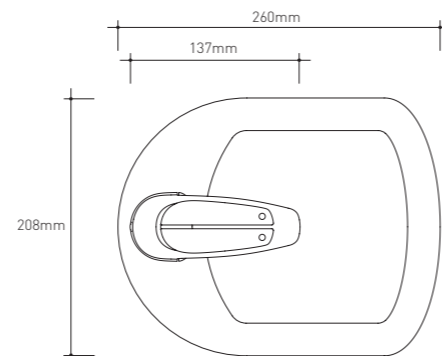

Billi Font benchtop layout



Filtered chilled and ambient drinking water system



Billi **Alpine**... a perennial source of refreshingly chilled, sparkling, crystal-clear drinking water.

A compact underbench drinking water appliance providing chilled and filtered water at the touch of a lever.



#### Great tasting water

Sparkling clean, filtered, chilled water is nature's most refreshing drink. The Billi **Alpine**'s dual-stage, large capacity water filtration system effectively removes or reduces undesirable sediment, chemicals, heavy metals, chlorine, pesticides, tastes and odour.

#### Advanced filtration

The Billi **Alpine** features an advanced design, water filtration system providing sparkling fresh water. Hygienic and convenient dual-stage filter cartridges ensure maximum effectiveness and an extended service life.

#### Choice of dispensers

A choice of dispensers are available with the Billi **Alpine** system. Cast from solid metal alloy, the dispensers are designed to withstand the rigours of high-use environments. Billi **Alpine** 060 and 120 models are supplied with the Slimline dispenser, while the Billi **Alpine** 125 model is supplied with the Dual-Temp Dispenser. Both dispensers are available in a choice of architectural finishes.

#### Slimline Dispenser

A choice of square or rounded slimline tap styles gives you the perfect opportunity to match it with surrounding design elements.

#### Dual-Temp Dispenser

The timelessly styled and durable Billi Dual-Temp Dispenser tap provides filtered water, both chilled and at mains temperature. Levers can be pressed for single cup delivery or lifted for continuous flow. A swivel action allows the dispenser to be swung out of the way if more sink space is required. User friendly and ergonomically designed, the levers conform to the current Australian Standards for ease of use by people with a disability.

#### Billi Font – water where you want it

The stainless steel Billi Font harmonises perfectly with the **Alpine** Dispenser and allows installation away from the traditional sink area. Designers have greater flexibility as the Billi Font can be easily installed where it is most needed.

#### High energy efficiency

The unique Billi **Alpine** Chiller system is designed to be extremely energy efficient. The **Alpine**'s refrigeration system has a large chilling capacity, yet draws only a small electrical current, so running costs are minimal.

Note: Cover image includes Font kit. This is an accessory and should be ordered separately to the unit.



Innovative Billi **Alpine** design... a pleasure to use

#### Compact design

The Billi **Alpine** Chiller module is designed to fit comfortably within a standard shelf compartment. Its compact design allows easy installation while maximising useable cupboard space.

#### Whisper quiet

As the innovatively designed Billi **Alpine** Chiller has no fan, it is whisper quiet, vibration-free and completely unobtrusive in operation.

#### No cupboard venting

Venting of the cupboard area is not required when installing a Billi **Alpine**, simplifying installation and space requirements. Air clearance around the unit is not needed and there are no grilles to keep clean or any noisy energy-consuming fans.

#### Leakguard detection system

For peace of mind, the **Alpine** 125 features a watertight base tray and water detection system. Should leakage ever occur, water supply to the system will be instantly shut off.

#### Variable temperature

The Billi **Alpine** features an easily adjustable control knob to vary the chilled water temperature to suit the user's requirements. Water temperature may be raised during the winter months and lowered during summer for cold, refreshing drinks.

#### Easy-change replacement filters

Replacing the **Alpine** filter cartridge couldn't be simpler. Flashing amber dispenser icons indicate when replacement is due. The swing-change filter simply swings forward and slides off. Fitting the new filter is just as easy: slide filter in and swing back. Cartridge locks into place and a flushing cycle begins automatically.

#### Simple Installation

Installation of a Billi **Alpine** is a simple task. Colour-coded flexible tubing and easy-connect fittings ensure a rapid and trouble-free operation.

#### Options and accessories

- **Finishes:** Standard finish for the **Alpine** Dispenser is Bright Chrome. Optional finishes include Brushed and Black Chrome.
- **Billi Font:** Allows the **Alpine** to be located away from sink areas. Finished in polished Stainless Steel. Optional finishes include Brushed and Black Chrome.
- **Dispenser Riser:** 70mm dispenser extension - supplied standard with the Billi Dual-Temp Font. Optional finishes include Brushed and Black Chrome.
- **1000mm Tubing Extension Kit:** Allows the dispenser to be offset from the underbench unit.
- **Optional Dispenser Style:** The Billi **Alpine** 060 and 120 are supplied standard with the round slimline dispenser. Optional style; Square profile slimline dispenser.

#### Specifications and guide to model selection

Product Code	Billi <b>Alpine</b> model	Dispenser type	Initial cup delivery and suggested no. of persons	Chilled water delivery cups per hour	Height mm	Width mm	Depth mm
932060	<b>Alpine</b> 060	Round Slimline	12	60	340	180	460
932120	<b>Alpine</b> 120	Round Slimline	20	120	340	180	460
932125	<b>Alpine</b> 125	Dual-Temp	20	120	340	180	460

1 cup = 170mL. \*Based on the initial number of cups of chilled water immediately available, drawn at one cup every 10 seconds. Consideration may be needed for usage patterns and drawn off methods.