

B-5000
Instant Boiling and Chilled
Filtered Water System

Installation guide



Installation requirements.

—Billi B-5000 system components

1. Underbench module
2. Dispenser tap upper with tubing
3. Dispenser base and mount
4. Barb locking bush
5. 4mm chrome screw and allen key
6. Large washer
7. Tube spring clamps x 3
8. 450mm flexible braided hose
9. Filter cartridge (installed)
10. Billi B-5000 User guide
11. Warranty certificate

—Determine unit location

Plan the installation. Dispenser tube lengths, position of power and water outlets, required air space around the underbench module and access for service must be considered before cutting tube lengths. Refer to Diagrams 1, 2 and 3 for clearances around the dispenser and unit. Unit must be installed horizontally with plastic vent panel facing to front of cupboard. The B-5000 is designed for internal installation only.

—Water supply

The B-5000 must only be connected to a cold water supply. A 15mm stop tap (not supplied) is to be installed in an easily accessible position within 450mm from the B-5000 water supply inlet. Supply pressure: 200 – 1000 Kpa
Supply temperature: 5°C – 30°C
DO NOT install with water that is microbiologically unsafe or with water of unknown quality without adequate disinfection before the system. Systems certified for cyst reduction may be used on disinfected water that may contain filterable cysts.

—Ventilation

The B-5000 requires cupboard ventilation, adequate air space and an unobstructed clearance of at least 25mm on each side of the underbench unit. Door ventilation is to be provided by spacing the door gap with rubber stoppers.

—IMPORTANT

Insufficient ventilation will cause inefficient refrigeration system operation, increasing power usage.

—Power requirements

A single 10 amp standard power outlet is required. B-5000 module is supplied with 1 metre of flex cord and plug.

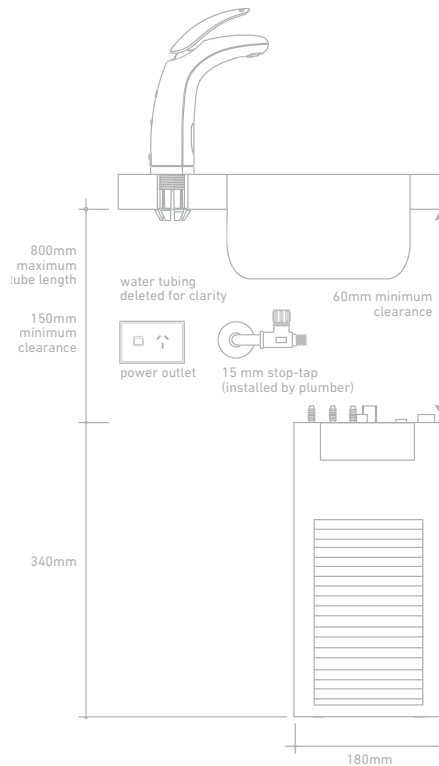

Diagram 1

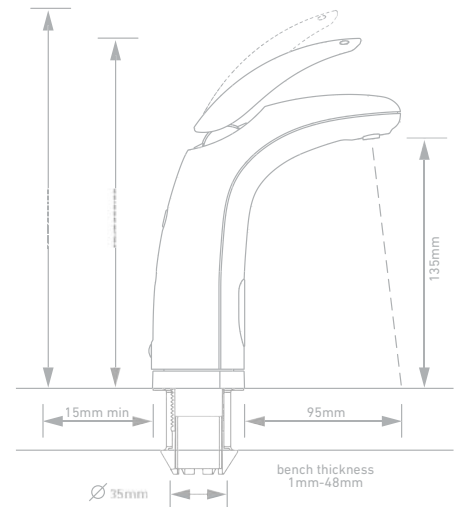

Diagram 2

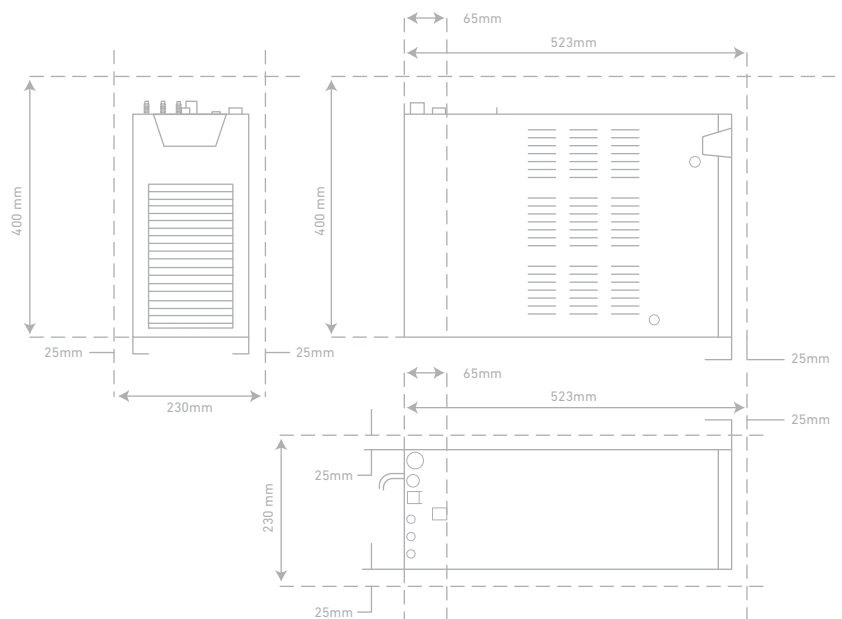

Diagram 3

Installing dispenser.

—IMPORTANT

This Billi appliance is to be installed by a licensed tradesperson in accordance with AS 3500.4 or AS/NZ 3500.4.2 and in compliance with applicable state regulatory requirements. For correct operation of this appliance, it is essential to observe the manufacturer's instructions.

—Plan dispense position

Determine the position of dispenser mounting hole in sinktop or benchtop. Refer to Diagram 2 for clearances allowed. Dispenser base template may be cut out and used to assist in correct positioning. Refer to Diagram 7. Hole size required is 35mm.

—Stainless steel sinktop

A suitable 35mm hole punch (Part no: 857901) is available as an accessory from Billi Pty Ltd. If possible, cut hole with die mounted below sinktop surface so that burr is pulled downwards. Alternatively remove burr and radius edge of hole with a fine file. This allows barbed dispenser mount to slide smoothly into mounting hole. Oil hole punch regularly. Lubricate surface to be cut with detergent.

—Timber/laminate benchtop

Maximum benchtop thickness is 48mm. Cut 35mm hole in appropriate position. When drilling through a particle board benchtop, take care to avoid a large chip breaking away as drill breaks through underside surface. We recommend drilling a small pilot hole through the benchtop, partially drilling the 35mm hole from underneath and then completely drilling the hole from above. The large 30mm washer supplied may be used to secure barb where underside particle board benchtop has chipped away.

—Fit dispenser base

- Cut a 35mm hole in sinktop or benchtop. Remove burr if protruding upwards.
- Press barbed mounting shaft through mount hole. Finger tighten nut.
- Insert barb locking bush as shown in Diagram 4.
- Ensure barb is centred in mount hole before tightening. Check position of base ring and gasket.
- Moderately tighten locking nut using multigrips or spanner. Take care to avoid overtightening nut which may break the plastic threaded shaft.
- Cut off excess threaded shaft with a hacksaw.

—IMPORTANT

Remove burrs and check internal bore is completely smooth.

—Fit dispenser head assembly

- Lay dispenser head assembly alongside mounting base assembly.
- Feed dispenser tubing and loom through centre hole in the following order:
 - Dispenser power cord.
 - Grey vent silicone tube. Feed tube until reducing joint passes through mount assembly – see Diagram 6.
 - Red and blue silicone tubing. To assist feeding the tubing, we recommend using silicone spray lubricant. Do not attempt to force tubing through with a pointed object as silicone tube is easily punctured. Check tubing is not kinked or twisted.
- Turn dispenser head assembly to approximately 60° from the straight ahead position of dispenser base. Slide head assembly onto base assembly whilst gently pulling tubing downwards from underneath to prevent tubing bunching and kinking. Mounting lugs will pass nut and slide down the 3 grooves on the swivel bearing.
- Once fully down, turn dispenser to straight ahead position. Fit chrome plated M4 retaining screw to lower rear threaded hole and tighten using the allen key supplied. Check dispenser now swivels smoothly 45° in each direction.

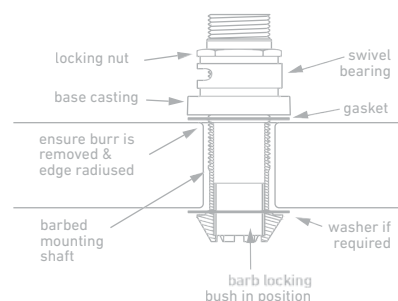

Diagram 4

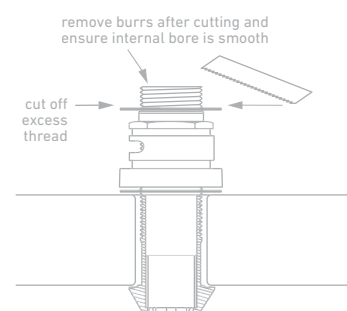

Diagram 5

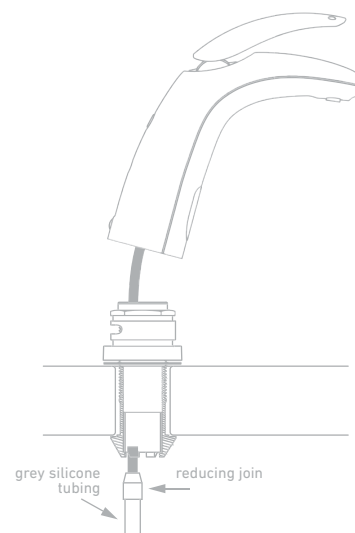

Diagram 6

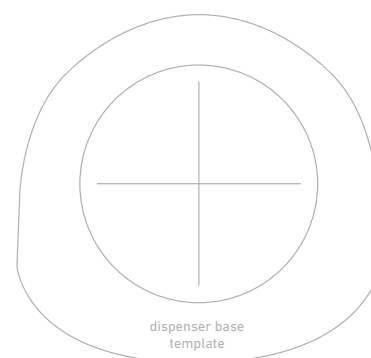

Diagram 7

Installing underbench module.

WARNINGS.

—Flush water supply

Flush water supply pipework before installing the underbench unit by connecting 450mm flexible braided hose to the supply tap and running water into a bucket.

—Install underbench unit

Take care to observe minimum clearances. This is particularly important with air-cooled models. Ensure there is adequate access to service the unit.

—Connect dispenser tubing and electrical plug

Connect all tubing and electrical plug as shown in Diagram 8 and 9. Ensure correct orientation of dispenser power plug before insertion. Trim tubes to correct lengths using a sharp knife or plastic tube cutter. Avoid leaving excess tubing which will sag, trapping water. Fit spring clamps supplied to retain silicone rubber tubing to barbed fittings

—IMPORTANT

Boiling outlet (red) and vent tube (grey) must not be kinked and must be installed with a continual fall.

—Commission the System

- Turn blue temperature control knob to OFF.
- Turn electricity supply ON at wall outlet.
- Turn water supply tap ON.
- Check that there are no leaks.

—Enter pipe length calibration mode

To enter SETUP mode, turn on the unit and wait for normal operation. Now depress both the Hot and Cold levers and while they are down, press and hold the safety switch for 3 seconds until the display has changed to yellow, then release the switch and both levers. Once in SETUP mode, repeat the procedure for entering setup – this will take you to the pipe length calibration mode. The red and blue tap indicators will now blink: blue slowly and red faster.

—To change the pipe length

- Press and release the hot lever to reduce the pipe length.
- Press and release the cold lever to increase the pipe length.
- After each press wait for the tap to demonstrate the dispense operation. No water should be dispensed when the correct length is selected.

The best way to determine the correct pipe length setting is to increase the length (by pressing the cold lever) until a splash of water is observed, then decrease the length (by pressing the hot lever) until no splash is observed.

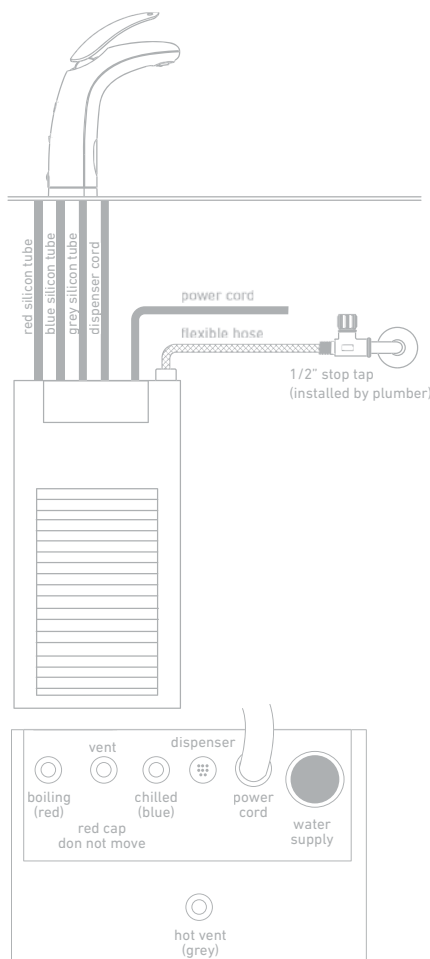

Diagram 8 and 9

Press the safety switch to save the new settings.

—Flush the unit

- Latch cold lever into the UP position.
- When cold water stops running, return cold lever to OFF position.
- Wait for 10 minutes.
- Latch cold lever into the UP position.
- When cold water stops running, return cold lever to OFF position.
- Latch hot lever into the UP position.
- When hot water stops running, return hot lever to OFF position.

—For continued safety of this appliance it must be installed, operated and maintained in accordance with the manufacturer's instructions.

—Your appliance should be installed by a suitably qualified tradesperson.

—For correct operation of this appliance it is essential to observe the instructions as outlined in this booklet.

—Do not use this appliance with water that is microbiologically unsafe or with water of unknown quality without adequate disinfection before the system. Systems certified for cyst reduction may be used on disinfected water that may contain filterable cysts.

—Filter replacement must be performed at intervals of not more than 6 months.

—Use this appliance only as directed in these instructions and only for its designed purpose.

—This appliance is not intended for use by persons (including children) with reduced physical, sensory or mental capabilities, or lack of experience and knowledge, unless they have been given supervision or instruction concerning use of the appliance by a person responsible for their safety.

—Children should be supervised to ensure that they do not play with the appliance.

—DANGER: The operation of the thermal cut-out indicates a possibly dangerous situation. Do not reset the thermal cut-out until the water heater has been serviced by a qualified person.

—WARNING: Do not connect any restrictor or pressure relief device to the vent pipe of this water heater if installed.

—If the supply cord is damaged, it must be replaced by the manufacturer, its service agent or similarly qualified persons in order to avoid a hazard.

—New hose-sets supplied with the appliance are to be used and old hose-sets should not be re-used.

Billi Pty Ltd
42 Lucknow Crescent, Thomastown
Victoria 3074 Australia

Telephone +61 3 9469 0400
Facsimile +61 3 9469 0499

www.billihome.com.au

Designed and manufactured in Australia.

As Billi Pty Ltd has a policy of continual improvement, all details are subject to change without notice. All goods are sold subject to our published terms and conditions. Billi is a registered trademark. 0610