

HOME DATA SHEET

Alpine Spring 65

Billi™

Billi Alpine Spring 65

Ideal for al fresco, entertaining, BBQ areas or the home bar, this high volume solution offers bottomless chilled and sparkling water on tap from a compact underbench system.

The versatile Alpine Spring 65 allows rapid bottle filling to keep your family, friends or guests hydrated and is delivered complete with installation kit and font tray accessory.



Dual Cobra Head Dispenser

Alpine Spring 65 Under-Bench Unit



Features



* Italian design & made Sparkling unit

PRODUCT SPECIFICATIONS

Water type	Product code	Model name	Dispenser	Power supply (amps)	Suggested usage
<p>CHILLED SPARKLING</p>	842205	Alpine Spring 65	Dual Cobra Head	10	<ul style="list-style-type: none"> • Drinking water filtration • Bottle filling • Entertainment

Accessories

Chilled & Sparkling Decals (included)

Install Kit (included)

Font tray (included)

Dual Cobra Head dispenser (included)



Finishes

Standard Finish

CH - Chrome

TECHNICAL DRAWING & INSTALLATION REQUIREMENTS

PRODUCT DIMENSIONS

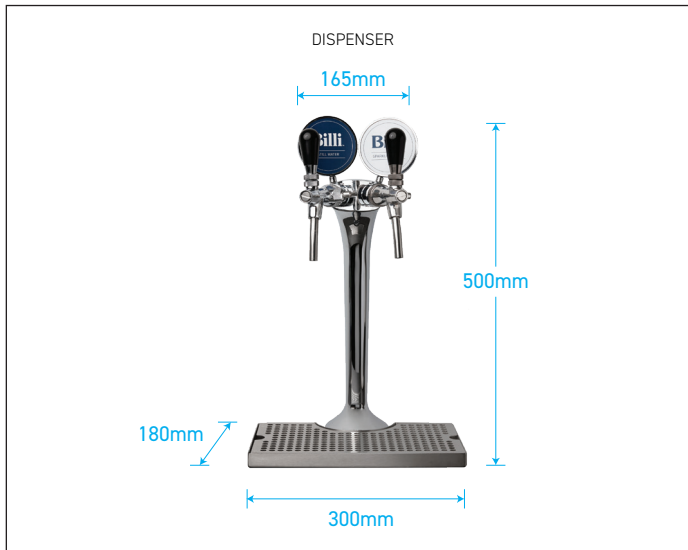

PREFERRED INSTALLATION LAYOUT

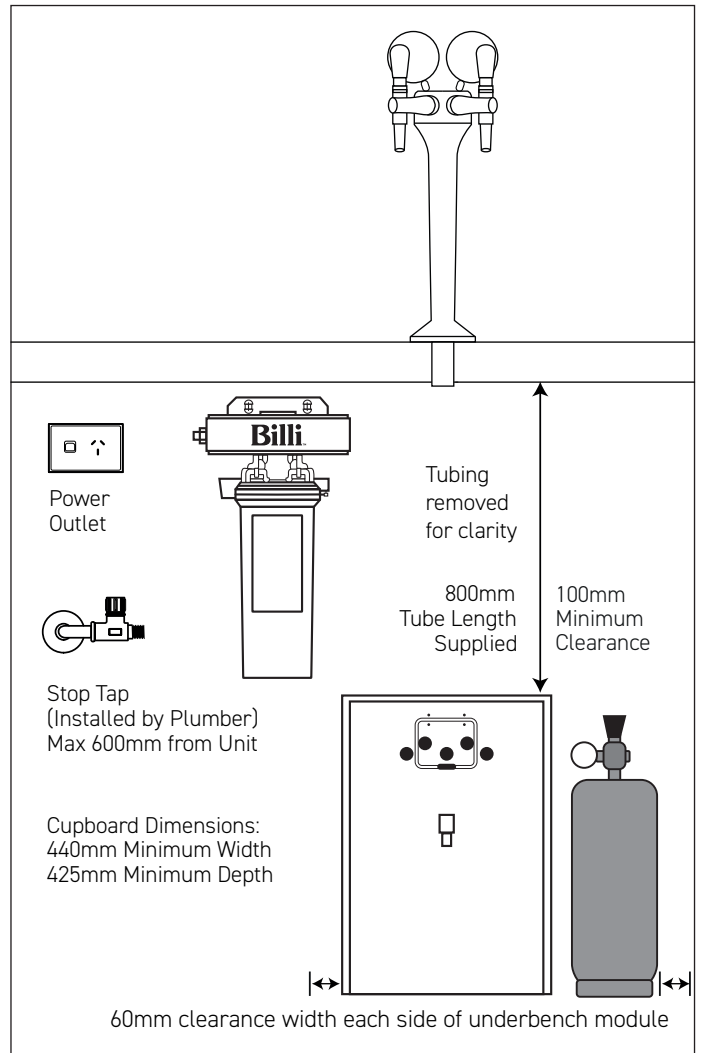

WATER SUPPLY

A single cold water supply point with a 1/2" BSP stop tap is required. Stop tap is to be installed in an easily accessible position, within 600 mm of the inlet to the boiling water module. Dynamic supply pressure: Min. 250 kPa, max 600kPa. Supply temp min 5°C, max 30°C.

POWER SUPPLY

A single 10 amp GPO is required installed in an accessible position. Refer to Diagram 1. Power circuits must be fitted with an earth leakage protection device (RCD). Chilled water module is supplied with a 1 meter flex cord and plug.

CERTIFICATIONS

Every Billi drinking water appliance is manufactured under a certified quality control system. All Billi commercial range models have been tested and comply with all required standards including: Watermark: WM-022607; Certified to AS/NZ3498 and AS/NZ 4020; ISO9001:2015, QEC 11627; HACCP: PE-872-WAT-2-02; WELL Cornerstone Member.

WARRANTY

The Billi Alpine Spring range is covered by a comprehensive 2 year warranty on all parts and labour.

Billi™

Billi Australia Pty Ltd
42 Lucknow Crescent,
Thomastown, Victoria
3074 Australia

P 1800 812 321
F +61 3 9469 0499
W www.billi.com.au

visit us at



Designed and manufactured in Australia to the highest quality standards